

SUMMIT SCHEDULE

FUTURE FACILITIES SUMMIT



CONNECT with the right people

BUILD long-term relationships
that lead to business

INCREASE operational efficiency
and reduce energy costs

FMA Summits - Connecting all facets of the Intelligent Building.

Your hub for smart, connected and high performance facilities solutions!



October 19th - 21st, 2015 Marriott Teaneck at Glenpointe, Teaneck, NJ



Day 1 - Monday October 19, 2015

6:00 - 8:00 Cocktail Reception Sponsorship by US LED, Ltd. - Grand Ballroom Exhibit Area

Day 2 -Tuesday October 20, 2015

| Time | Presentation Title | Presenter(s) Name(s) | Presenter(s) Title(s) | Organization |
|---------------|---|----------------------|--|--------------------------------------|
| 7:30 - 8:30 | Breakfast - Manhattan Room | | | |
| 8:30 - 8:50 | BASF Center for Building Excellence | Andrew Wagner | Architect | BASF Corporation |
| | | Moses Clark | National Account Manager | |
| 8:50 - 9:10 | Compressed Air System Efficiency: Capturing and Sustaining Energy Savings | Wayne Perry | Technical Director | Kaeser Compressors, Inc. |
| 9:10 - 9:30 | Reduce Costs & Take Control with Distributed Energy Resources | Woody Rubin | Vice President AES Energy Solutions | AES Distributed Energy, Inc. |
| | | Sam Ley | Energy Systems Engineer | |
| 9:30 - 9:50 | Fuel Cells: Offering Businesses a Competitive Advantage Through Energy Savings, Security and Environmental Leadership | Kent McCord | Director of Marketing | Doosan Fuel Cell America |
| 9:50 - 10:10 | Shining a New Light on Your Bottom Line | Kendra Paschall | VP Sales | Every Watt Matters |
| 10:10 - 10:30 | Sustainable Energy Efficiency | Micheal Stears | Principal | Solution Dynamics, LLC |
| 10:30 - 11:00 | Break - Grand Ballroom Exhibit Area | | | |
| 11:00 - 11:20 | Servicing, Delighting, Hosting, and Entertaining: ...And We Have to Give You Sustainability, Too? | Gary Levitan | Senior Manager of Energy & Utilities | Hudson's Bay Company |
| 11:20 - 11:30 | Automated Energy Storage: Helping Make Buildings Smarter | Randy Parole | Senior Account Executive | Stem |
| 11:30 - 11:50 | The Solar Gateway: A Long-Term View on Energy Solutions & Savings | Erik Schiemann | Global Solar Business Leader | GE Solar |
| 11:50 - 12:10 | Essential Insights into Today's Global LED Lighting Providers | Bob Cantarutti | President | Emium Lighting |
| 12:10 - 12:30 | MetalynxNA Modular Wiring System | Mark Matheny | Vice President - US Sales | Wieland Electric Inc. |
| 12:30 - 1:30 | Lunch - Manhattan Room | | | |
| 1:30 - 1:50 | Accelerating towards an Energy Efficient Future for New York City - the Road to 80x50 | John Lee | Deputy Director | NYC Mayor's Office of Sustainability |
| 1:50 - 2:10 | Making Dumb Buildings Smart | Harry Sim | CEO | Cypress Envirosystems |
| 2:10 - 2:30 | LED Lighting - Questions to ask and why you need to know - Case Study & Workshop | Bill Burke | Director of Sales | US LED, Ltd. |
| 2:30 - 2:50 | Smart Buildings Have Promised a Lot. Use Analytics to Make them Deliver | Keith LaRose | Director of Business Development | CopperTree Analytics |
| 2:50 - 3:20 | Break - Grand Ballroom Exhibit Area | | | |
| 3:20 - 3:40 | How Anthem Reduced Annual Utility Costs by \$1.5 million in One Year | Hakon Mattson | Director of Energy and Sustainability | Anthem, Inc. |
| 3:40 - 4:00 | LED Lighting - The Easiest Way to Improve Energy Efficiency and Uncover Cost Savings | Jim Hunter | Senior Vice President of Sales and Marketing | MaxLite |
| 4:00 - 4:20 | Green Combustion Retrofits That Pay For Themselves | Gerald Blain | Regional Manager | Ware |
| 4:20 - 7:30 | Cocktail Reception Sponsorship by Kaeser Compressors Inc. - Grand Ballroom Exhibit Area | | | |

Day 3 - Wednesday October 21, 2015

| Time | Presentation Title | Presenter(s) Name(s) | Presenter(s) Title(s) | Organization |
|---------------|---|----------------------|---|--|
| 7:30 - 8:30 | Breakfast - Manhattan Room | | | |
| 8:30 - 9:00 | The Convergence of Facilities & IT Data Center | MaryAnn Ibeziako | Director of Engineering and Energy | University of Maryland |
| 9:00 - 9:20 | Reducing Energy Costs with Smart Building Software | Gary Kohrt | Vice President of Solutions and Services | ICONICS |
| 9:20 - 9:40 | Reduce HVACR Water And Chemical Consumption With Dolphin WaterCare® | Anupam Bhargava | President | Dolphin WaterCare |
| 9:40 - 10:00 | GI ENERGY | Dave Yanni | SVP Strategy and Business Development | GI Energy |
| 10:00 - 10:20 | Energy: Cost or Profit Center? | Chris Cantone | Chief Sales & Marketing Officer | CPower |
| 10:20 - 10:35 | Break - Grand Ballroom Exhibit Area | | | |
| 10:35 - 11:05 | An International Approach to Sustainability | Dr.Steven Driver | Global Energy Program Manager | Genzyme Global Engineering and Technology |
| 11:05 - 11:15 | Environmental Sensors & Energy Management Solutions | Alexie Holstein | Application Engineer | Veris Industries |
| 11:15 - 11:45 | Electronics in Your Facility: Plague or Profit? | Carol Baroudi | Global Sustainability and Compliance | Arrow Value Recovery |
| 11:45 - 12:15 | Knowledge is Power (Savings) | Alicia Hunt | Director of Energy & Environment | City of Medford, Massachusetts, Office of Energy & Environment |
| 12:15 - 1:15 | Lunch - Manhattan Room | | | |
| 1:15 - 1:45 | Greening Washington Square Campus | John Bradley | Associate Vice President | New York University |
| 1:45 - 2:15 | Implementing a Whole-Building Energy Retrofit For The Empire State Building | Dana Schneider | Managing Director, Energy and Sustainability Projects | JLL |

THANK YOU FOR ATTENDING THE FUTURE FACILITIES SUMMIT.

Our upcoming 2016 Summit:



Future Facilities Summit 3: May 16th - 18th, 2016

Sheraton Lisle Hotel, Chicago, IL

Our Future Facilities Summit connects solution providers with building owners and facility managers who are responsible for the operational intelligence and energy efficiency of commercial, light industrial, institutional and retail facilities from fortune 500 & 1000 companies across North America. This event is focused on bringing together companies that offer the best solutions from building automation, renewable energy and facilities management to reduce energy cost and increase productivity.



The AES Corporation (NYSE: AES) is a Fortune 200 global power company. We provide affordable, sustainable energy to 18 countries through a diverse portfolio of distribution businesses as well as thermal and renewable generation facilities. A workforce of 18,500 people is committed to operational excellence and meeting the world's changing power needs. Our U.S.-based generation facilities serve customers throughout the country, including California, Hawaii, Indiana, Maryland, Ohio, Oklahoma and Pennsylvania.



Albireo Energy provides intelligent building solutions and energy efficiency to commercial and institutional buildings nationally. Our solutions and services include designing, installing and optimizing building automation solutions, lighting systems, and electrical power monitoring technologies to help building owners and managers improve efficiency and reduce operational costs while improving comfort for tenants.



BASF Center for Building Excellence serves as a conduit to the depth and breadth of BASF's innovative technologies and provides tailored solutions for design and construction challenges. The Center for Building Excellence is staffed by an interdisciplinary team of building science professionals, architects and engineers, and is focused on the adoption of beyond-code construction that is sustainable, affordable, and provides value for all stakeholders.



BrandPoint Services provides superior national refresh programs by utilizing an exclusive network of highly vetted trades. BrandPoint is part of FirstService Brands, which also includes CertaPro Painters, Floor Coverings International, California Closets and Paul Davis Restoration to name a few. In addition to painting, BrandPoint Services offers removal and installation of flooring, ceilings panels, graphics, fixtures and other general repairs.



Experience Matters and Cogeneration Consultants has it. For more than 20 years, we've completed scores of CHP energy projects across the United States. Highly focused in our approach, clients benefit from customized solutions that result from a greater involvement and fuller understanding of the projects goals and challenges. Agile, responsive and committed to the project's success, Cogeneration Consultants stands ready to assist in realizing the CHP energy solution most advantageous for the facility.



CollectiveView is a SaaS company that delivers a complete IWMS/CAFM suite of real estate solutions. CollectiveView customizes the solution to meet our clients real estate, facility, and project management needs. CollectiveView has successfully implemented IWMS solutions for over 25MM sqft and currently works with multiple Fortune 100 companies nationally and internationally.



The newest member of the Delta Connects group, CopperTree Analytics is a start-up drawing upon 30 years of smart building experience -- and we're on a mission to make sure automated buildings finally deliver on their promises. The solution? Energy management software + fault detection integrated into one system. Now you have the tools you need to reduce energy consumption, pinpoint your maintenance programs, and improve your building's performance.



CPower is a leading provider of demand response and peak demand management services to commercial and industrial customers in the U.S. We work collaboratively with our customers, helping them reduce their energy spend by providing solutions that maximize savings, monetize energy assets, optimize operational earning potential and reach sustainability goals. For more information, visit www.cpowercorp.com.



Cypress Envirosystems provides technologies to retrofit existing facilities to improve energy efficiency and lower maintenance costs. We have patented solutions for upgrading legacy pneumatic HVAC controls, automatically detecting faults in Steam Traps, reducing energy use for compressed air systems etc. Our customers include numerous Fortune 500 companies, hospitals, universities, hospitality and government.



Dolphin WaterCare® has been providing environmentally responsible water treatment solutions for over a decade. Our state-of-the-art, patented technology, known as The Dolphin, is installed in over 5,000 systems globally. Our organization is dedicated to treating water responsibly. We are focused exclusively on solutions that support water and energy savings, while contributing to pollution prevention and the reduction of greenhouse gas emissions. For more information please visit www.dolphinwatercare.com.



Doosan Fuel Cell America, Inc. (Doosan) is a subsidiary of Doosan Corporation, a South Korea-based industrial company founded in 1896 that has current operations in 38 countries and has been a Fortune Global 2000 company since 2007. Doosan, headquartered in South Windsor, Connecticut, designs, engineers and manufactures the 400kW PureCell® fuel cell system for commercial and industrial applications. The PureCell system can operate 24/7 with high efficiency and ultra-low emissions, empowering customers to generate their own electricity and heat onsite while reducing their utility expenses and environmental emissions. With over 11 million fleet operating hours, Doosan fuel cells continue to demonstrate unparalleled durability and reliability.



Emium was founded in 2009 when company President Bob Cantarutti committed to leverage his years of global supply chain experience and relationships he developed in the high tech manufacturing industry to build a quality, value driven LED lighting supply organization. Emium prides itself in knowing how to filter through the existing LED lighting maze to identify the factories that consistently provide some of the best LED lighting products in the world.



Enertiv is a leading energy data and analytics company based in New York City. The company specializes in the collection, visualization and analysis of real-time energy data in buildings. Using a combination of proprietary meters and sensors (made in USA), as well as by integrating with existing building systems, Enertiv makes real-time energy consumption in buildings 100% transparent down to the equipment-level and provides highly actionable insights to help clients save money and save energy. The company has developed powerful software tools for various users including building owners, operators and occupants - such as mobile applications and interactive dashboards. The company has several fortune 500 clients and was recently named one of the Top 12 Energy Analytics Companies to Watch in 2015.



Ephesus Lighting, Inc. is a US-based company that designs and manufactures high-output LED lighting solutions for challenging applications in the industrial and sporting markets. Ephesus is focused on innovating advanced LED solutions that will enrich and illuminate the world by creating brighter, more vibrant and more sustainable environments.



Every Watt Matters (EWM) is a leading international provider of turn-key energy efficient lighting system upgrades. We are passionate about reducing energy consumption without sacrificing light quality. We are dedicated to lowering operational costs through energy and maintenance reduction strategies. EWM provides whole facility lighting system energy use analysis and implements lighting upgrades to help commercial, industrial and government customers meet their energy reduction and sustainability goals. Our energy efficiency services include: lighting energy analysis, value-engineered designs, managed installations and utility incentive procurement. EWM' in-house ESCO can enter into shared savings contracts.



GE Solar specializes in developing on-site, turnkey solar systems for commercial and industrial customers, working collaboratively with them to develop a customized solar solution that meets their unique, long-term energy needs.



Generac Power Systems, Inc. is a global leader in Commercial and Industrial Power Generation. Generac designs, manufactures, and distributes highly reliable power products, services and solutions. Generac manufactures and assemble component parts via a flexible, vertically integrated manufacturing philosophy, which means that they design source and build solutions from the ground up. Generac builds single engine power generators from 800 Watts to 2,000 Kilowatts and paralleled solutions up to 100 Megawatts.



GI Energy designs solutions that perfectly match our clients' needs and that are ideally suited to the buildings they operate. We don't specialize in a single technology – to do so would limit the options of our design teams and engineers. We have deep expertise across the whole range of on-site and microgrid energy technologies, including: Cogeneration (CHP), Geothermal, Solar, Energy storage.



ICONICS is an award-winning independent software provider, and Microsoft 2014 Public Sector CityNext Partner of the Year, offering real-time BACnet-integrated visualization, HMI/SCADA, energy management, fault detection, manufacturing intelligence, MES and a suite of analytics solutions for operational excellence. Our products are used in building automation, renewable energy, utilities, water/wastewater, oil and gas, pharmaceuticals, automotive, and many other applications.



Kaeser is the leader in providing reliable and energy efficient compressed air systems for the industrial user. At the same time, we recognize that products are only part of the efficiency picture. The greatest efficiency gains are achieved through proper system design. In the course of helping many customers achieve better energy and production efficiencies, Kaeser has refined air audit techniques. The result is our Air Demand Analysis program, offering a unique combination of affordability, convenience, and completeness. As an ENERGY STAR Partner, Kaeser is committed to helping industrial users increase compressed air system performance while saving energy and reducing maintenance costs.



MaxLite has been committed to providing energy-efficient lighting products for more than 20 years. A three-time ENERGY STAR Partner of the Year, MaxLite offers an extensive line of state-of-the-art indoor and outdoor LED lamps and luminaires under the MaxLED brand.



Design, manufacture and sale of industrial grade LED Lamps & Fixtures for the Commercial Lighting Industry. We specialize in providing cost effective LED replacement for HID lamps with fast ROI of 1~2 years. Our LED lamps are competitively priced and produced in a "form factor" perfectly fitting the complete range of HID Lamps from 50W to 1,500W.



Solution Dynamics is a nationwide energy cost management company providing a variety of services to large industrials, central plants, and critical environment facilities. Services include: corporate strategic program development & management, and the evaluation, development, implementation, measurement and verification of energy cost reduction opportunities. They have extensive experience in optimizing processes and infrastructure allowing them to quickly identify and achieve significant energy savings using "risk free" methodologies.



Stem's turnkey, fully-automated, Li-ion based solution anticipates and shaves costly peaks, and taps into demand response revenues without disrupting operations. The systems are designed for safe, seamless building integration and can typically be installed by standard electricians in only a day or two. The standard payment model is a subscription, so Stem customers enjoy positive cash flow from day one – typically saving more than twice what they pay.



US LED has business roots going back thirty years based on strong values, customer service, valued employees and quality products. Headquartered in Houston, TX, US LED is a global leader in LED lighting serving many commercial, industrial and high tech industries. With an award winning engineering team producing proven, revolutionary technology, US LED continues to provide new and innovative products to the market. US LED is Always the Right Choice!



Veris Industries is a premier provider of environmental sensors and energy management solutions, and is recognized for setting the standard in customer service and product innovation. Veris' products integrate with a facility's main automation system providing valuable feedback on energy consumption, and helping to regulate and decrease a facilities energy use.



For over 60 years Ware has been a provider of Industrial and commercial boiler system, including all axillary equipment. Our products and designs range from 10 hp to 500,000 pph/unit. Specializing in combustion and control energy retrofits. Ware is also one of the largest mobile boiler rental companies. In addition Ware provides Heat recovery, Training, Valve repair and chemical cleaning solutions and on line parts sales at www.boilerwarehouse.com.



Wieland Electric Inc. is the US subsidiary of Wieland Electric GmbH headquartered in Bamberg, Germany. A 105 year old privately held company, Wieland is among the pioneers in electrical connection technology. We are an international market leader in the area of pluggable installation solutions for commercial and institutional buildings.

MARRIOTT

TEANECK AT GLENPOINTE, TEANECK, NJ

FUTURE FACILITIES SUMMIT



SUMMIT FLOORPLAN

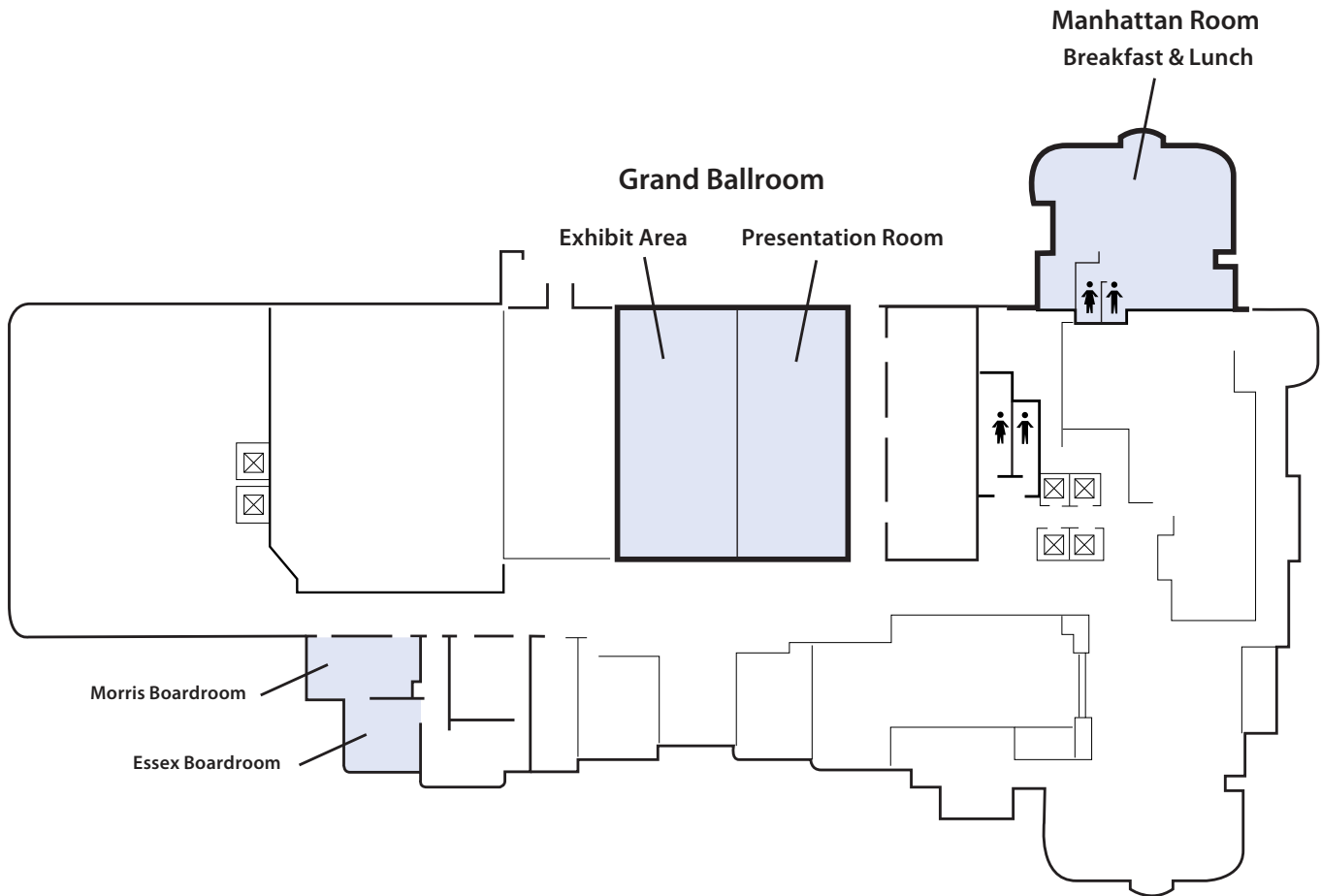

LOBBY LEVEL